

JCY48 SERIES

CONTACT CONFIGURATION: SPST, LATCHING

MAIN CONTACT DATA

- I THERMAL, Ith: 300 AMPS
- RESISTIVE LOAD: 300 AMPS @ 60 VDC MAX
- OVERLOAD: 450 AMPS PER UL 508
- CONTACT VOLTAGE DROP: <40 mV TYPICAL
- MATERIAL: AgSnO2

COIL DATA

- COIL VOLTAGES: 12 - 340 VDC
- COIL TYPES: CONTINUOUS DUTY INTERMITTENT DUTY

- PULSED COIL VOLTAGE
- MINIMUM PULSE DURATION: 150 ms
- POSITIVE ON TERMINAL A1 TO OPEN
- POSITIVE ON TERMINAL A2 / RED DOT TO CLOSE

OPTIONS

- AUXILIARY CONTACTS
- 5 AMPS, 250VAC
- FORM C SPDT
- MOUNTING BRACKETS
- SERATED CONTACTS
- COIL SUPPRESSION
- FLYING LEADS
- ACV COIL W/ RECTIFIER

- TEMPERATURE: -20°C TO +50°C
- MECHANICAL LIFE: > 3 X 10⁶
- IP CODE: IP31 PER IEC 60529
- APPROXIMATE WEIGHT: 0.9 kg [2.0 lbs]
- RoHS COMPLIANT
- TELECOM UL FILE: E161810
- RECOMMENDED TORQUE, M5: 15 In-Lb [1.7 Nm] MAX.

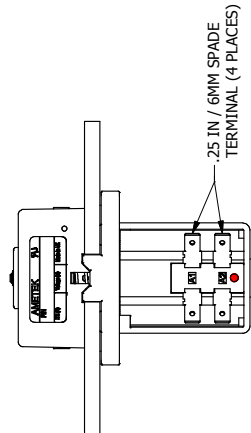
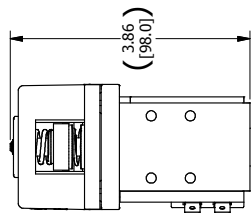
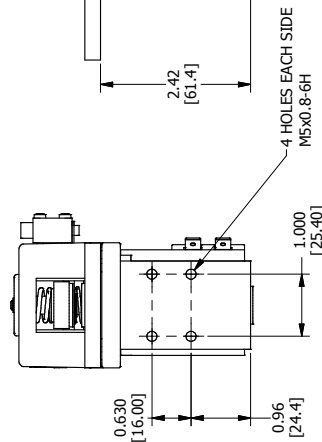
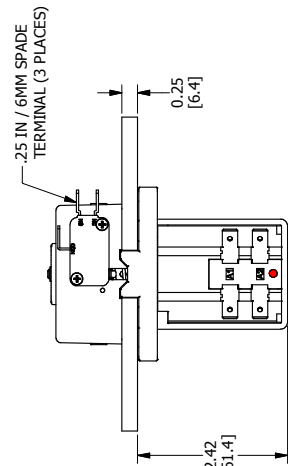
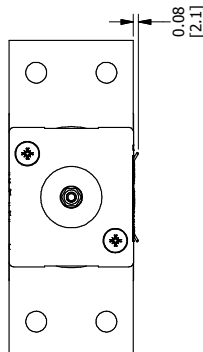
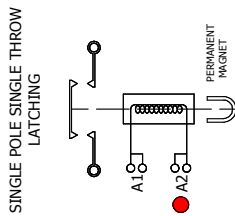
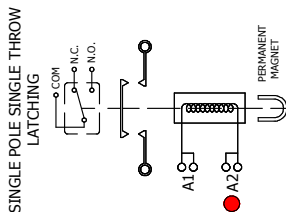
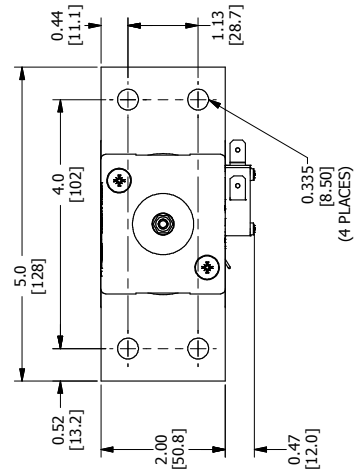

CHANGE RECORD	UNLESS OTHERWISE SPECIFIED:	REVISION	DATE	BY	REASON
1	DESIGN	1	09-08-10	JCY	INITIAL RELEASE
2	DESIGN	2	09-08-10	JCY	DESIGN CHANGES FOR MOUNTING BRACKET
3	DESIGN	3	09-08-10	JCY	DESIGN CHANGES FOR MOUNTING BRACKET
4	DESIGN	4	09-08-10	JCY	DESIGN CHANGES FOR MOUNTING BRACKET
5	DESIGN	5	09-08-10	JCY	DESIGN CHANGES FOR MOUNTING BRACKET
6	DESIGN	6	09-08-10	JCY	DESIGN CHANGES FOR MOUNTING BRACKET
7	DESIGN	7	09-08-10	JCY	DESIGN CHANGES FOR MOUNTING BRACKET
8	DESIGN	8	09-08-10	JCY	DESIGN CHANGES FOR MOUNTING BRACKET
9	DESIGN	9	09-08-10	JCY	DESIGN CHANGES FOR MOUNTING BRACKET
10	DESIGN	10	09-08-10	JCY	DESIGN CHANGES FOR MOUNTING BRACKET
11	DESIGN	11	09-08-10	JCY	DESIGN CHANGES FOR MOUNTING BRACKET
12	DESIGN	12	09-08-10	JCY	DESIGN CHANGES FOR MOUNTING BRACKET
13	DESIGN	13	09-08-10	JCY	DESIGN CHANGES FOR MOUNTING BRACKET
14	DESIGN	14	09-08-10	JCY	DESIGN CHANGES FOR MOUNTING BRACKET
15	DESIGN	15	09-08-10	JCY	DESIGN CHANGES FOR MOUNTING BRACKET
16	DESIGN	16	09-08-10	JCY	DESIGN CHANGES FOR MOUNTING BRACKET
17	DESIGN	17	09-08-10	JCY	DESIGN CHANGES FOR MOUNTING BRACKET
18	DESIGN	18	09-08-10	JCY	DESIGN CHANGES FOR MOUNTING BRACKET
19	DESIGN	19	09-08-10	JCY	DESIGN CHANGES FOR MOUNTING BRACKET
20	DESIGN	20	09-08-10	JCY	DESIGN CHANGES FOR MOUNTING BRACKET
21	DESIGN	21	09-08-10	JCY	DESIGN CHANGES FOR MOUNTING BRACKET
22	DESIGN	22	09-08-10	JCY	DESIGN CHANGES FOR MOUNTING BRACKET
23	DESIGN	23	09-08-10	JCY	DESIGN CHANGES FOR MOUNTING BRACKET
24	DESIGN	24	09-08-10	JCY	DESIGN CHANGES FOR MOUNTING BRACKET
25	DESIGN	25	09-08-10	JCY	DESIGN CHANGES FOR MOUNTING BRACKET
26	DESIGN	26	09-08-10	JCY	DESIGN CHANGES FOR MOUNTING BRACKET
27	DESIGN	27	09-08-10	JCY	DESIGN CHANGES FOR MOUNTING BRACKET
28	DESIGN	28	09-08-10	JCY	DESIGN CHANGES FOR MOUNTING BRACKET
29	DESIGN	29	09-08-10	JCY	DESIGN CHANGES FOR MOUNTING BRACKET
30	DESIGN	30	09-08-10	JCY	DESIGN CHANGES FOR MOUNTING BRACKET
31	DESIGN	31	09-08-10	JCY	DESIGN CHANGES FOR MOUNTING BRACKET
32	DESIGN	32	09-08-10	JCY	DESIGN CHANGES FOR MOUNTING BRACKET
33	DESIGN	33	09-08-10	JCY	DESIGN CHANGES FOR MOUNTING BRACKET
34	DESIGN	34	09-08-10	JCY	DESIGN CHANGES FOR MOUNTING BRACKET
35	DESIGN	35	09-08-10	JCY	DESIGN CHANGES FOR MOUNTING BRACKET
36	DESIGN	36	09-08-10	JCY	DESIGN CHANGES FOR MOUNTING BRACKET
37	DESIGN	37	09-08-10	JCY	DESIGN CHANGES FOR MOUNTING BRACKET
38	DESIGN	38	09-08-10	JCY	DESIGN CHANGES FOR MOUNTING BRACKET
39	DESIGN	39	09-08-10	JCY	DESIGN CHANGES FOR MOUNTING BRACKET
40	DESIGN	40	09-08-10	JCY	DESIGN CHANGES FOR MOUNTING BRACKET
41	DESIGN	41	09-08-10	JCY	DESIGN CHANGES FOR MOUNTING BRACKET
42	DESIGN	42	09-08-10	JCY	DESIGN CHANGES FOR MOUNTING BRACKET
43	DESIGN	43	09-08-10	JCY	DESIGN CHANGES FOR MOUNTING BRACKET
44	DESIGN	44	09-08-10	JCY	DESIGN CHANGES FOR MOUNTING BRACKET
45	DESIGN	45	09-08-10	JCY	DESIGN CHANGES FOR MOUNTING BRACKET
46	DESIGN	46	09-08-10	JCY	DESIGN CHANGES FOR MOUNTING BRACKET
47	DESIGN	47	09-08-10	JCY	DESIGN CHANGES FOR MOUNTING BRACKET
48	DESIGN	48	09-08-10	JCY	DESIGN CHANGES FOR MOUNTING BRACKET
49	DESIGN	49	09-08-10	JCY	DESIGN CHANGES FOR MOUNTING BRACKET
50	DESIGN	50	09-08-10	JCY	DESIGN CHANGES FOR MOUNTING BRACKET
51	DESIGN	51	09-08-10	JCY	DESIGN CHANGES FOR MOUNTING BRACKET
52	DESIGN	52	09-08-10	JCY	DESIGN CHANGES FOR MOUNTING BRACKET
53	DESIGN	53	09-08-10	JCY	DESIGN CHANGES FOR MOUNTING BRACKET
54	DESIGN	54	09-08-10	JCY	DESIGN CHANGES FOR MOUNTING BRACKET
55	DESIGN	55	09-08-10	JCY	DESIGN CHANGES FOR MOUNTING BRACKET
56	DESIGN	56	09-08-10	JCY	DESIGN CHANGES FOR MOUNTING BRACKET
57	DESIGN	57	09-08-10	JCY	DESIGN CHANGES FOR MOUNTING BRACKET
58	DESIGN	58	09-08-10	JCY	DESIGN CHANGES FOR MOUNTING BRACKET
59	DESIGN	59	09-08-10	JCY	DESIGN CHANGES FOR MOUNTING BRACKET
60	DESIGN	60	09-08-10	JCY	DESIGN CHANGES FOR MOUNTING BRACKET
61	DESIGN	61	09-08-10	JCY	DESIGN CHANGES FOR MOUNTING BRACKET
62	DESIGN	62	09-08-10	JCY	DESIGN CHANGES FOR MOUNTING BRACKET
63	DESIGN	63	09-08-10	JCY	DESIGN CHANGES FOR MOUNTING BRACKET
64	DESIGN	64	09-08-10	JCY	DESIGN CHANGES FOR MOUNTING BRACKET
65	DESIGN	65	09-08-10	JCY	DESIGN CHANGES FOR MOUNTING BRACKET
66	DESIGN	66	09-08-10	JCY	DESIGN CHANGES FOR MOUNTING BRACKET
67	DESIGN	67	09-08-10	JCY	DESIGN CHANGES FOR MOUNTING BRACKET
68	DESIGN	68	09-08-10	JCY	DESIGN CHANGES FOR MOUNTING BRACKET
69	DESIGN	69	09-08-10	JCY	DESIGN CHANGES FOR MOUNTING BRACKET
70	DESIGN	70	09-08-10	JCY	DESIGN CHANGES FOR MOUNTING BRACKET
71	DESIGN	71	09-08-10	JCY	DESIGN CHANGES FOR MOUNTING BRACKET
72	DESIGN	72	09-08-10	JCY	DESIGN CHANGES FOR MOUNTING BRACKET
73	DESIGN	73	09-08-10	JCY	DESIGN CHANGES FOR MOUNTING BRACKET
74	DESIGN	74	09-08-10	JCY	DESIGN CHANGES FOR MOUNTING BRACKET
75	DESIGN	75	09-08-10	JCY	DESIGN CHANGES FOR MOUNTING BRACKET
76	DESIGN	76	09-08-10	JCY	DESIGN CHANGES FOR MOUNTING BRACKET
77	DESIGN	77	09-08-10	JCY	DESIGN CHANGES FOR MOUNTING BRACKET
78	DESIGN	78	09-08-10	JCY	DESIGN CHANGES FOR MOUNTING BRACKET
79	DESIGN	79	09-08-10	JCY	DESIGN CHANGES FOR MOUNTING BRACKET
80	DESIGN	80	09-08-10	JCY	DESIGN CHANGES FOR MOUNTING BRACKET
81	DESIGN	81	09-08-10	JCY	DESIGN CHANGES FOR MOUNTING BRACKET
82	DESIGN	82	09-08-10	JCY	DESIGN CHANGES FOR MOUNTING BRACKET
83	DESIGN	83	09-08-10	JCY	DESIGN CHANGES FOR MOUNTING BRACKET
84	DESIGN	84	09-08-10	JCY	DESIGN CHANGES FOR MOUNTING BRACKET
85	DESIGN	85	09-08-10	JCY	DESIGN CHANGES FOR MOUNTING BRACKET
86	DESIGN	86	09-08-10	JCY	DESIGN CHANGES FOR MOUNTING BRACKET
87	DESIGN	87	09-08-10	JCY	DESIGN CHANGES FOR MOUNTING BRACKET
88	DESIGN	88	09-08-10	JCY	DESIGN CHANGES FOR MOUNTING BRACKET
89	DESIGN	89	09-08-10	JCY	DESIGN CHANGES FOR MOUNTING BRACKET
90	DESIGN	90	09-08-10	JCY	DESIGN CHANGES FOR MOUNTING BRACKET
91	DESIGN	91	09-08-10	JCY	DESIGN CHANGES FOR MOUNTING BRACKET
92	DESIGN	92	09-08-10	JCY	DESIGN CHANGES FOR MOUNTING BRACKET
93	DESIGN	93	09-08-10	JCY	DESIGN CHANGES FOR MOUNTING BRACKET
94	DESIGN	94	09-08-10	JCY	DESIGN CHANGES FOR MOUNTING BRACKET
95	DESIGN	95	09-08-10	JCY	DESIGN CHANGES FOR MOUNTING BRACKET
96	DESIGN	96	09-08-10	JCY	DESIGN CHANGES FOR MOUNTING BRACKET
97	DESIGN	97	09-08-10	JCY	DESIGN CHANGES FOR MOUNTING BRACKET
98	DESIGN	98	09-08-10	JCY	DESIGN CHANGES FOR MOUNTING BRACKET
99	DESIGN	99	09-08-10	JCY	DESIGN CHANGES FOR MOUNTING BRACKET
100	DESIGN	100	09-08-10	JCY	DESIGN CHANGES FOR MOUNTING BRACKET

JCY48 SERIES
 TRIP: 090-8376, U.S.A.
 CONTACTOR, SPST, LATCHING
 UNLESS THIS DRAWING IS BEING VIEWED FROM THE REVERSE SIDE, IT IS AN UNCONTROLLED DOCUMENT. DESTROY ALL COPIES AFTER INITIAL USE.